

# ***Corberó***

# WASHING MACHINE OWNER'S MANUAL

Model

---

CLT1204VIN

---

• Before using your washing machine, please read this manual carefully and keep it for future reference.

• The drawings in this manual are for instruction only, it may be vary from the model you buy.



# **CONTENTS**

---

Products Specification	01
Safety Precaution	02
Important Hints	04
Overview of Washing Machine	05
Install Washing Machine	06
Operate Washing Machine	08
Maintenance	14
Troubleshooting	15
Appendix	17
Products Fiche	19

---

# **PRODUCTS SPECIFICATION**

---

**Voltage:**220-240V~/50Hz

**Water Pressure:**0.05-0.8MPa

<b>Model</b>	<b>Capacity</b>	<b>Rated Power</b>	<b>Outer Dimension (W*D*H) mm</b>
CLT1204VIN	12kg	1950W	595*650*850

## **⚠ NOTE:**

1. All the pictures in the manual are used for schematic only.It may be different from the machine you buy.
- 2.The actual function and the data in kind prevail.

### **! WARNING**

To reduce the risk of fire,electric shock,or injury to persons when using your appliance, follow basic precautions,including the following

- If the power cord is damaged,it must be replaced by the manufacturer, service agent or similarly qualified persons in order to avoid the hazard.
- The new hose-sets supplied with the washer are to be used and that old hose-sets should not be reused.
- This appliance is not intended for use by persons(including children)with reduced physical,sensory or mental capabilities,or lack of experience and knowledge,unless they have been given supervision or instruction concerning use of the appliance by a person responsible for their safety.Children should be supervised to ensure that they do not play with the appliance.(This warning is not for EUROPEAN market)
- This appliance can be used by children aged from 8 years and above and persons with reduced physical,sensory or mental capabilities or lack of experience and knowledge if they have been given supervision or instruction concerning use of the appliance in a safe way and understand the hazards involved.Children shall not play with the appliance.Cleaning and user maintenance shall not be made by children without supervision.(This warning is for EUROPEAN market)
- Carpet does not obstruct the opening for washing machine with ventillation openings in the base.
- Children of less than 3 years should be keep away unless continuously supervised.
- This appliance is inteded to be used in household and similar applications such as:
  - staff kitchen areas in shops,offices and other working environments;
  - farm houses
  - by clients in hotels,motels and other residential type environments;
  - bed and breakfast type environments;
  - areas for communal use in blocks of flats or launderettes.
- Take care that power voltage and frequency shall be identical to those of washing machine.
- To ensure your safety,power cord plug must be inserted into an earthed socket.Check carefully and make sure that your socket is proper and earthed reliably.
- Do not use any socket with rated current less than that of washing machine.
- Do not operate your washer when parts are missed or broken.
- Never pull out power plug with wet hands.

## **SAFETY PRECAUTION**

---

- Replace immediately worn power cord, loose plugs/power sockets.
  - Unplug your washer before cleaning or making any repair.
- Please check whether the water inside the drum has been drained before opening the door. Please do not open the door if there is any water visible.
- Glass door may be very hot during the operation. Keep kids and pets far away from the washer during the operation.
  - Make sure that the water and electrical device must be connected by a qualified technician in accordance with the manufacturer's instruction and local safety regulations.
  - Before operating this machine, all packages and transit bolts must be removed. Otherwise, the washing machine may be seriously damaged while washing the clothes.
  - Flammable and explosive or toxic solvents are forbidden. Gasoline and alcohol etc. shall not be used as detergents. Please only select the detergents suitable for machine washing.
  - Be careful of scald while the washer draining hot washing water.
  - Never unplug your washer by pulling on the supply cord. Always grasp the plug firmly and pull straight out from the outlet.
  - If your old appliance is not being used anymore, we recommend that you remove the door and cut off the supply cord.
  - Packing materials may be dangerous to the kids. Please keep all packing materials (plastic bags, foams etc) far away from the kids.
  - Do not climb up and sit on top cover of the machine.
  - Pets and kids may climb into the machine. Check the machine before every operation.
  - Do not lean against the door of the washer.

## ***IMPORTANT HINTS***

---

- The household washing machine isn't intended to be built-in.
- This washing machine is for indoor using only.
- Make sure that all pockets are empty. Sharp and rigid items such as coin, brooch, nail, screw or stone etc. May cause serious damages to the washer.
- Please remember to disconnect water and power supply immediately after the clothes are washed.
- The washing machine shall not be installed in bath room or very wet rooms as well as in the rooms with explosive or caustic gases.
- Before washing the clothes at first time, the washing machine shall be operated in one round of the whole procedures without the clothes inside.
- Do not repair or replace any part of the washer unless you have been specifically recommended in the user-repair instructions and you have the knowledge and skills to make it.
- It is forbidden to wash carpets and bras inset with steel wire.
- Never refill water by hand during washing.
- After the program is completed, please wait for two minutes to open the door.
- When handling the machine, the accumulated water shall be drained out of the machine firstly. Handle the machine carefully. Never hold each protruded part on the machine while lifting. Machine door can not be used as the handle during the conveyance.
- The washing machine with single inlet valve only can be connected to the cold water supply. The washing machine with double inlet valves can be connected to the hot water and cold water supply.

## SAVE THESE INSTRUCTIONS

THE MACHINE IS HOUSEHOLD USE ONLY

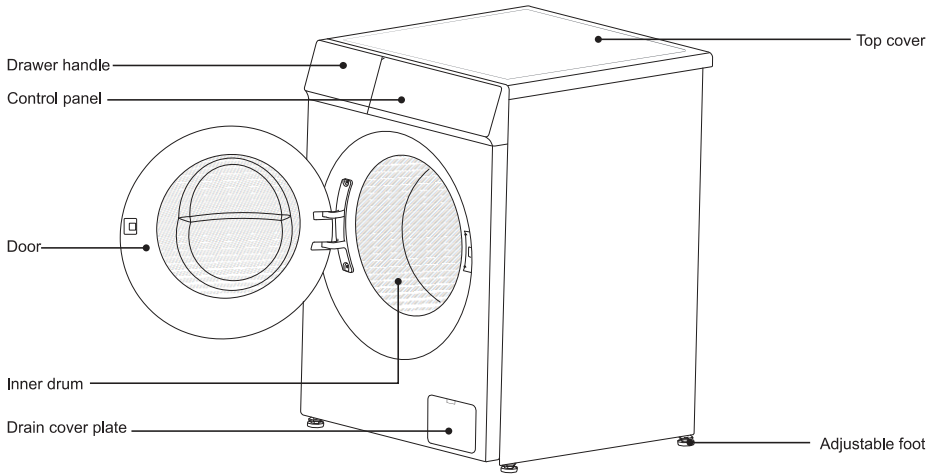

### ■ Product accessories

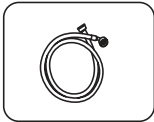

Cold water pipex1



Hot water pipex1  
(applicable to double  
-inlet models)

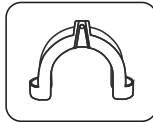

Inlet pipe bracket  
x1

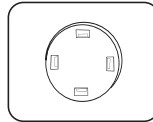

Transport bolt hole  
coverx4

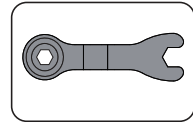

Wrenchx1  
(for adjusting the foot and  
removing the transport bolt)

Note: Check whether all the accessories shown above are complete. If the washing machine is damaged or accessories are not complete during shipment, please contact the dealer immediately.

# INSTALL WASHING MACHINE

## ■ Removal of transport bolts

- In order to prevent internal damage to the machine during transportation, 4 transport bolts are installed on the back of the machine.
- Please be sure to remove the transport bolts before using the washing machine. If not, strong vibration, noise and failure may occur.
- If you need to transport the washing machine, please be sure to reinstall the transport bolts to prevent damage to the inside of the machine during transportation.

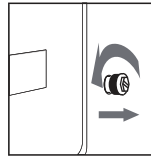
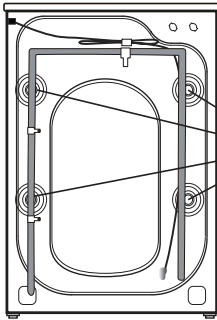

1. Loosen the transport bolt counterclockwise with a wrench until it is loose and falling off.

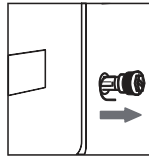

2. Pull out the transport bolt.

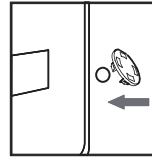

3. Cover the transport bolt hole plug.

## ■ Leveling of the washing machine

- Do not place the washing machine outdoors or in a place where the ambient temperature is lower than 0°C; it cannot be placed on a carpet or wooden floor; it should be placed on a firm and flat ground with an inclination angle of less than 10°.
- If the washing machine is unstable due to the uneven ground, the adjustable feet at the bottom of the washing machine can be adjusted to keep the washing machine stable.
- During the adjustment process, pressure is applied to the diagonal line of the top cover of the washing machine. If the washing machine shakes, the adjustable feet must be readjusted.

1. Loosen the lock nuts above the rubber feet, and adjust the height of 4 adjustable feet to make the feet close to the ground smoothly without shaking.

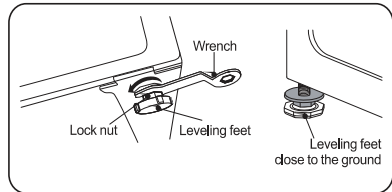

2. After leveling, adjust the nuts above the 4 rubber feet with a wrench to lock the 4 adjustable feet.

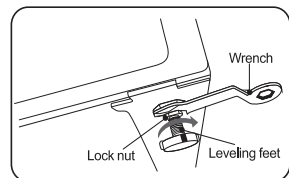

# INSTALL WASHING MACHINE

The provided water hose may differ depending on the model. Please follow the instruction according to the provided water hose.

## ■ Connect the inlet hose

Connecting to a threaded water tap

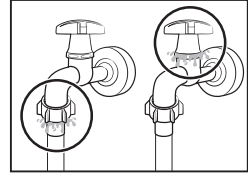
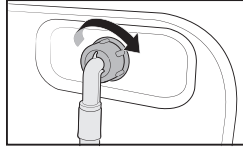
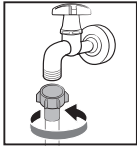

1. Connect the water hose to the water tap, and then turn the connector clockwise as shown.
2. Connect the other end of the water hose to the inlet valve on the back of the washing machine. Turn the hose clockwise to tighten.
3. Open the water tap and check if there are any leaks around the connection areas. If there are water leaks, repeat the steps above.

Connecting to a non-threaded water tap

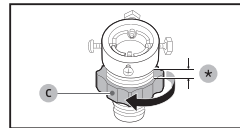
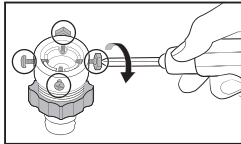
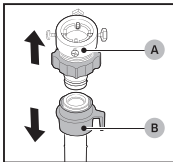

1. Remove the **adaptor (A)** from the water **hose (B)**.
2. Use a Phillips screwdriver to loosen four screws on the adaptor.
3. Hold the adaptor and turn **part (C)** in the arrow direction to loosen it by 5mm (\*).

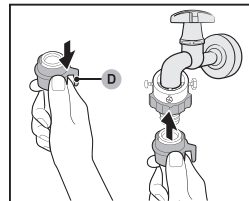
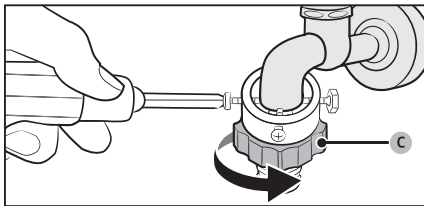

4. Insert the adaptor onto the water tap, and then tighten the screws while lifting the adaptor.
5. Turn **part (C)** in the arrow direction to tighten it.
6. While pulling down **part (D)** on the water hose, connect the water hose to the adaptor. Then, release **part (D)**. The hose fits into the adaptor with a clicking sound.
7. To complete connecting the water hose, see 2 and 3 on the "Connecting to a threaded water tap" section.

## ■ Installation of drain pipe

In order to prevent siphonage, the drain pipe should be installed at a height of 65-100cm, and the end of the drain pipe should not be immersed in water.

# OPERATE WASHING MACHINE

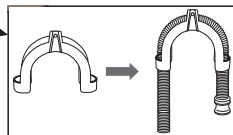
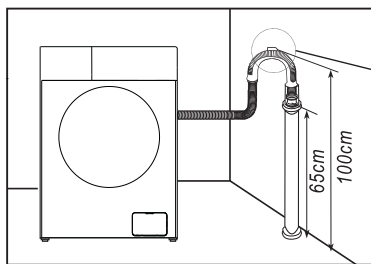

The drain pipe bracket can be used to fix the drain hose.

- Check the condition of the water pipe regularly to ensure that the pipe is not damaged, entangled or bent, and if necessary, replace the water pipe.
- Please fix the drain pipe before use, and confirm that the sewer is not blocked by foreign matter.
- If it is necessary to extend the water inlet or drain pipe, you can purchase it at a local after-sales service center.

## ■ Laundry tips



Please check the clothing label to confirm whether it is suitable for machine wash.



Please check the pockets of clothes and take out the items, such as coins, hairpins, keys, etc.



Tie long cross straps in a knot, do up buttons, and zip up.



Do not wash too much. Please unroll the clothes and shake them up before putting them in the washing machine.



When washing, in order to prevent the buttons from making a noise, please turn over the clothes with buttons before putting them in the washing machine.



## ■ Put detergent

1. Pull out the detergent drawer.
2. Add detergent for prewash into compartment I
3. Add detergent for main wash into compartment II
4. Add fabric softener into compartment.
5. Please choose suitable type of detergent for the various washing temperature to get the best washing effect with less water and energy consumption.

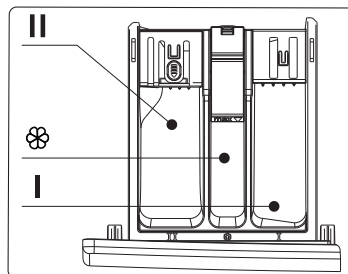

# OPERATE WASHING MACHINE

## ■ Control panel

\* The following illustration is a simple example of the model control panel. The illustration is for reference only. Please refer to the actual effect.

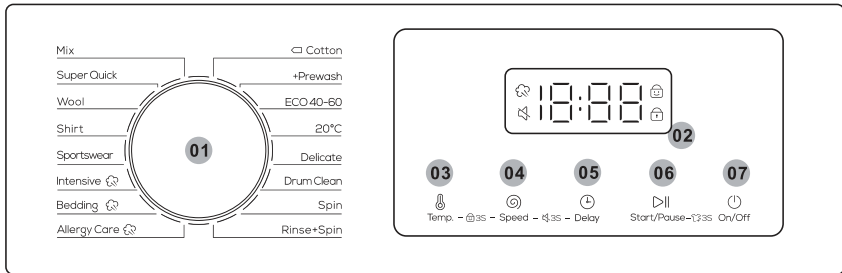

01 Cycle Selector	Turn the dial to select a cycle.
02 Display	The display shows current cycle information and estimated time remaining, or an information code when a problem occurs.
03 Temp.	Press to change the water temperature for the current cycle. Available temperature range depends on the cycle. The selected temperature will be displayed on the display.
04 Speed	Press to change the spinning speed for the current cycle. Available spin speed depends on the cycle. The selected spin speed will be displayed on the display.
05 Delay	Press Delay repeatedly to cycle through the available Delay options (from 3 to 24 hours in one hour increments).
06 Start/Pause	Press to Start/Pause operation. Press the button once to start a cycle. To pause operation, press the button again. You may change the cycle settings and options. To resume paused operation, press the button again.
07 On/Off	Press to turn On/Off the washing machine. If you turn on the washing machine and do not use it for 10 minutes, it will turn off automatically.

# OPERATE WASHING MACHINE

---

## Delay

You can set the washing machine to finish your wash automatically at a later time, choosing a delay of between 3 to 24 hours (in 1 hour increments). The hour displayed indicated the time the wash will finish.

1. Select a cycle. Then change the cycle settings if necessary.
2. Press **Delay** repeatedly until a desired end time is set.
3. Press **Start/Pause**.

The corresponding indicator turns on with the clock running.

4. To cancel the **Delay**, restart the washing machine by pressing **On/Off**.
- Real-life case

You want to finish a two-hour course 3 hours later from now. For this, you add the Delay option to the current cycle with the 3-hour setting, and press **Start/Pause** at 2:00 p.m. Then, what happens? The washing machine starts operating at 3:00 p.m., and ends at 5:00 p.m.

## Steam Wash Icon

If this icon is always bright, it means the Steam Wash function is enabled. Due to the different configuration of models, some models do not have this configuration, please refer to the actual model.

## Child Lock

To prevent accidents by children, Child Lock locks all buttons except for **On/Off**.

- To activate or deactivate the Child Lock function, press and hold **Temp.** and **Speed** simultaneously for 3 seconds.

When Child Lock is activated, the indicator  lights up.

## Alarm Off

You can turn on or off the sound of the cycle selector and all buttons.

- To turn on or off the sound, press and hold **Speed** and **Delay** simultaneously for 3 seconds. When the sound is off, the  indicator lights up.

## Door Lock

When the door is not closed or locked normally, the icon is not bright; Lock the door correctly, the icon is always bright.

## Reload

Long press the **Start/Pause** button for 3 seconds. After the lock is unlocked, the function of adding clothes in the middle can be started.

# ***OPERATE WASHING MACHINE***

---

## ■ Introduction to laundry procedures

<b>Program</b>	<b>Applicable of fabric to washing</b>
<b>Mix</b>	For mixed washing of cotton, linen and chemical fiber clothing
<b>Super Quick</b>	For quick washing of low-dirt light clothes (approx. 18 min)
<b>Wool</b>	For washing of wool fabrics
<b>Shirt</b>	For washing of shirts or light summer clothes
<b>Sportswear</b>	For washing of sportswear
<b>Intensive</b>	For washing of moderately or heavily stained clothes
<b>Bedding</b>	For washing of large/home textile clothing
<b>Allergy Care</b>	Featuring a high-temperature wash and extra rinses to help remove the remaining detergent effectively
<b>Cotton</b>	For washing of ramie cotton fabrics
<b>Prewash</b>	Add a preliminary washing process before starting the main cycle
<b>ECO 40-60</b>	For washing of normal clothes at a temperature of 40°C-60°C or below
<b>20°C</b>	For washing of warm clothes at a temperature of 20°C or below
<b>Delicate</b>	For washing of delicate clothes
<b>Drum Clean</b>	For cleaning of inner drum at high temperature
<b>Spin</b>	For separate dehydration of clothes
<b>Rinse + Spin</b>	For rinsing and dehydrating of clothes

Note: The washing procedures and parameters will also be different depending on the different model configuration. For details, the actual product shall prevail!

# OPERATE WASHING MACHINE

## ■ Table of Washing Procedures

- Washing efficiency and performance is determined by used detergent quality. Use only machine wash approved detergent.
- If need use specific detergent, e.g. for synthetic and woolen fabric.Mind always detergent manufacturer recommendations.
- Do not use dry cleaning agents such as trichloroethylene and similar products. Choose the best detergent.

Program	Max Load (kg)	Kind of detergent		
	12	Universal	Special	Softener
<b>Mix</b>	6	L/P	-	○
<b>Super Quick</b>	2	L/P	-	○
<b>Wool</b>	2	-	L/P	-
<b>Shirt</b>	5	L/P	L	○
<b>Sportswear</b>	5	L/P	-	○
<b>Intensive</b> 	12	L/P	-	○
<b>Bedding</b> 	10	L/P	L/P	○
<b>Allergy Care</b> 	6	L/P	L/P	○
 <b>Cotton</b>	12	L/P	-	○
<b>+ Prewash</b>	10	L/P	-	○
<b>ECO 40-60</b>	12	L/P	-	○
<b>20°C</b>	6	L/P	-	○
<b>Delicate</b>	6	L/P	L/P	-
<b>Drum Clean</b>	0	-	-	-
<b>Spin</b>	12	-	-	-
<b>Rinse + Spin</b>	12	-	-	○

L=gel-/liquid detergent P=Powder detergent O=optional -=no

If using liquid detergent, it is not recommended to activate the time delay.

We recommend by using: Laundry powder 20°C to 95°C; Wool detergent 20°C to 40°C;

\*Choose 95°C wash temperature only for special hygienic requirements.

# OPERATE WASHING MACHINE

---

## ■ Introduction of Other Functions

### Unlock of emergency door (not applicable in some models)

- If you want to take out the clothes when there is a long-time power cut, make sure the water level in the drum is below the safe level, the temperature is under 40°C, and the inner drum is does not rotate, then detach the drain hose and lower it, replace the hose after water runs out;
- Open the drain pump cover at the bottom right of the front side, pull down the rod lightly, when hearing a light sound then open the door and take out or put in the clothes;
- Replace drain pump cover;
- This method can only be used in emergency.

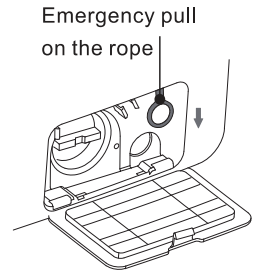

### Resume Function

- This machine has the resume function in case of power-down. If there is a power failure or plug loose in the process of machine, the machine can remember the working status and resume work when the power is restored.

### Cloth Weigh Awareness

- In the beginning of the washing, the machine will estimate the weight of the clothes and dispense the detergent automatically (on condition that there is enough detergent in the case), then decide the amount of the water accordingly to achieve the goal of saving water.

### Unbalance Protection

- When the machine is ready to spin, The washer may take a few time to balance clothes due to great unbalance.
- If clothes is still unbalance in the drum after that, the spinning speed can be slow down to avoid great vibration.
- If clothes in drum is too less, the machine may not to spin due to the unbalance protection, then you should add more clothes in the machine to make it to spin.

**Note:** Due to the product model upgrade, the function configuration may be different from this description, please take the actual model function as the standard!

# MAINTENANCE

Washing machine should be maintained in time after long-term use. Good maintenance habits will prolong the service life of the washing machine. Please pull out the power plug before maintenance to prevent danger. Please close the door of the laundry dryer after each use to prevent children from getting caught when playing.

## ■ Clean detergent drawer

1. Press down the part ① inside the drawer and take out the detergent drawer.
2. Lift the clip up and take out softener cover and wash all grooves with water.
3. Restore the softener cover and push the drawer into position.

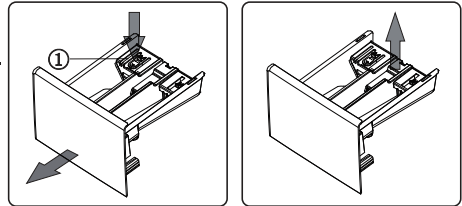

## ■ Clean the drain pump

(recommended once every six months)

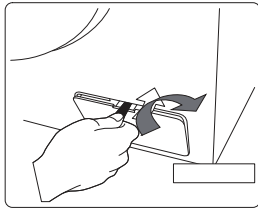

1: Remove the protective cover for the drain pump in the direction shown here with a sheet such as coin, etc.

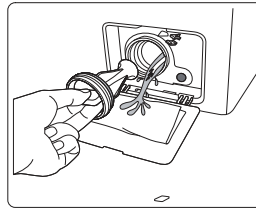

2: Slowly unscrew the pump cover of the drain pump (Pay attention to residual water), take out the laundry residue in the drain pump, and clean it thoroughly until the blades can rotate freely;

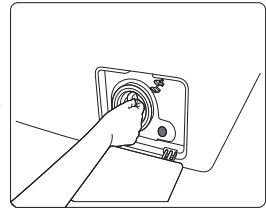

3: Install the pump cover and tighten it to make sure that there is no water leakage from the drain pump, as shown in the figure. Install the protective cover for the drain pump!

## ■ Clean the filter screen on the water inlet

(Recommended once every six months)

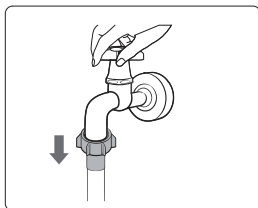

1: Turn off the faucet, remove the water inlet pipe from the faucet, and scrub the filter screen with a small brush.

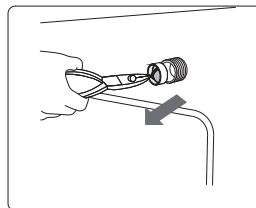

2: Unscrew the water inlet pipe from the back of the machine, pull out the filter screen with needle-nose pliers, clean it and reinstall it.

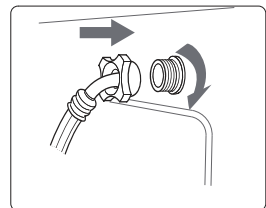

3: Reconnect the water inlet pipe. Turn on the faucet and check that there is no water leak.

NOTE: Please contact a technician if your washer is frozen.

# ***TROUBLESHOOTING***

---

<b>TROUBLES</b>	<b>SOLUTIONS</b>
There is some remaining water in the machine	This is normal and is the result of water tests performed at the factory
The washer does not run	Check if the power plug is inserted well. Check if the tap is opened. Check if the button "Power" is pressed. Check if the button "Start/Pause" is pressed. Check if the delay feature is activated.
Water leakage	Check and fasten inlet hose. Clean up drain hose and ask a specialized person to repair it when necessary.
Abnormal noise and great vibration	Check if the transit bolts has been removed. Check if the adjustable legs are adjusted level. Check if the washer is installed on the solid and level floor. Check if there are any barrettes or metal articles inside.
Washing efficiency is not satisfied	Select a proper procedure. Add the proper detergent quantity according to the instructions in detergent package.
The machine take no answer after press buttons	Check if the "Child-lock" feature has been activate. Press button "Start/Pause" first then press other buttons.
Actually running time of procedures is not corresponded to the display time	Check if clothes in the drum is dispersive enough. Check if the water is drain out or inflow well.
The washer fills while draining	Check if the max height of the drain hose is lower than 65cm Check if the drain hose is immersed.

# **TROUBLESHOOTING**























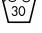
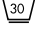

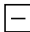
<b>DISPLAY</b>	<b>MEANS</b>	<b>SOLUTIONS</b>
<b>E 1</b>	The washer fills over time	Check if the tap is opened. Check if the water pressure is too low. Check if the inlet hose is blocked.
<b>E 2</b>	Water drainage over time	Check if the drain pump is blocked. Contact a technician if necessary.
<b>E 3</b>	Door lock is breakdown	Close the door well again. Check if the clothes is caught between the door and seal. Contact a technician if necessary.
<b>E 4</b>	Water is overflowed	Let the machine drain out water automatically until the water level is suitable for wash procedure. Contact a technician if necessary.
<b>E 5</b>	The electrical motor is breakdown	Please contact a technician.
<b>E 6</b>	The heater does not work	Please contact a technician.
<b>E 7</b>	There is a temperature sensor fault	Please contact a technician.
<b>E 9</b>	communication failures	Please contact a technician.
<b>E 10</b>	Inverter failures	Please contact a technician.
<b>EP</b>	The procedure running is not corresponded to the cycle that the knob points.	Turn the cycle selector to the cycle corresponded to the procedure working on.

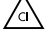
## **▲ NOTE**

Please refer to the actually purchased model for fault display here. Different models have different fault displays

# APPENDIX

## ■ Fabric Care Lable

	Resistant material		Can be ironed at 100°C max
	Delicate fabric		Do not iron
 	Item may be washed at 90°C		Can be dry cleaned using any solvent
 	Item may be washed at 60°C		Dry clean with perchloride, lighter fuel, pure alcohol or R113 only
 	Item may be washed at 40°C		Dry clean with aviation fuel, pure alcohol or R113 only
 	Item may be washed at 30°C		Do not dry clean
	Item may be hand washed		Dry flat
	Dry clean only		Can be hung to dry
	Can be bleached in cold water		Dry on clothes hanger
	Do not bleach		Tumble dry, normal heat
	Can be ironed at 200°C max		Tumble dry, reduced heat
	Can be ironed at 150°C max		Do not tumble dry

## ■ Electrical Warning

To avoid fire, electrical shock and other accidents, please remember the following reminding:

- Only the voltage indicated in power label can be used. If you are not clear of the voltage at home, please contact the local power bureau.
- When you are using the heating function, the maximum current through the washing machine will reach 10A. Therefore, please make sure the power supply units (current, voltage and cable) can meet the normal load requirements for the machine.
- Protect the power cord properly. Power cord shall be fixed well so that it will not trip the people or other things and be damaged. Special attention shall be paid to the plug location.
- Do not make the wall-mounted socket overloaded or cable extended. Over loading of the wiring may cause fire or electrical shock. Do not pull out power plug with wet hand.
- To ensure your safety, power plug shall be inserted into an earthed socket. Carefully check and ensure that your socket is properly and reliably earthed.

# APPENDIX

---

## ■ Protecting the environment

- The washer is manufactured by recyclable materials. If you decide to dispose of this washer, please observe the local waste disposal regulations. Cut off the power cord so that the washer cannot be connected to power. Remove the door so that small animals and children cannot get trapped inside the washer.
- Do not exceed the detergent quantities recommended in the detergent manufactures' instruction.
- Use stain removal products and blesches before the wash cycle only when strictly necessary.
- Save water and electricity by only washing full loads (the exact amount depends upon the program used).

## ■ Correct Disposal of this Product.



This marking indicates that this product should not be disposed with other household wastes throughout the EU. To prevent possible harm to the environment or human health from uncontrolled waste disposal, recycle it responsibly to promote the sustainable reuse of material resources. To return your used device, please use the return and collection systems or contact the retailer where the product was purchased. They can take this product for environmental safe recycling.

## ⚠ NOTE:

1. The energy efficiency rating was tested under "ECO 40-60" procedure.
2. Scan the QR code shown on the energy label for further product information.
3. When the washing machine gives error codes, make sure you contact our after sales team to repair. We shall not be responsible for any issue caused by unauthorised repair.
4. In case you need to order the accessories, we can send out within 15 working days after the request.
5. The display panel shall show "END" for 10 minutes after the cycle finish.
6. For the purpose of improving the performance of the whole washing machine, the appearance and specifications shall be changed without additional notice.

# ***PRODUCTS FICHE***

CLT1204VIN

Category Name	ECO 40-60			20°C	Cotton 95°C	Wool	Super Quick	Intensive
	100%Load	50%Load	25%Load					
Rated Capacity (kg)	12.0	6.0	3.0	6.0	12.0	2.0	2.0	12.0
Program Duration (h:min)	4:00	3:00	3:00	0:50	2:19	0:44	0:15	2:08
Energy Consumption (kWh/cycle)	0.860	0.512	0.232	0.260	1.670	0.132	0.061	0.910
Water Consumption (L/cycle)	80	55	46	48	72	64	39	78
Max Temperature (°C)	32	28	24	20	76	20	17	40
RMC (%)	53.9	53.9	53.9	82	72	78	90	75
Spinning Speed (rpm)	1400	1400	1400	600	800	400	800	800

# **PRODUCTS FICHE**

Supplier's name or trade mark: Corberó

Supplier's Address:

Model Identifier: CLT1204VIN

General Product Parameters:

Parameter	Value		Parameter	Value		
Rated Capacity (kg)	12.0		Dimensions in cm	Height	85	
				Width	60	
				Depth	65	
EEI <sub>w</sub>	41.6		Energy efficiency class	A		
Washing Efficiency Index	1.031		Rinsing effectiveness (g/kg)	5.0		
Energy consumption in kWh per cycle, based on the ECO40-60 programme. Actual energy consumption will depend on how the appliance is used.	0.436		Water consumption in litre per cycle, based on the ECO40-60 programme. Actual water consumption will depend on how the appliance is used and on the hardness of the water.	56		
Maximum temperature inside the treated textile (°C)	Rated Capacity	32	Remaining moisture content (%)	53.9	Rated Capacity	53.90
	Half	28			Half	53.90
	Quarter	24			Quarter	53.90

# PRODUCTS FICHE

Spin speed (rpm)	Rated capacity	1400	Spin-drying efficiency class	B
	Half	1400		
	Quarter	1400		
Programme duration (h:min)	Rated capacity	4:00	Type	free-standing
	Half	3:00		
	Quarter	3:00		
Airborne acoustical noise emissions in the spinning phase(dB(A) re 1 pW)	76		Airborne acoustical noise emission class (spinning phase)	B
Off-mode (W)	0.50		Standby mode (W)	—
Delay start (W) (if applicable)	4.00		Networked standby (W) (if applicable)	—

Minimum duration of the guarantee offered by the supplier : 3 years

This product has been designed to release silver ions during the washing cycle	NO
--	----

## **PRODUCTS FICHE**

PARAMETER	UNIT	VALUE
Rated capacity for the ECO40-60 programme, at 0,5 kg intervals (c)	kg	12. 0
Energy consumption of the ECO40-60 programme at rated capacity ( $E_{W,full}$ )	kWh/cycle	0. 860
Energy consumption of the ECO40-60 programme at half rated capacity ( $E_{W,1/2}$ )	kWh/cycle	0. 512
Energy consumption of the ECO40-60 programme at quarter rated capacity ( $E_{W,1/4}$ )	kWh/cycle	0. 232
Weighted energy consumption of the ECO40-60 programme ( $E_W$ )	kWh/cycle	0. 436
Standard energy consumption of the ECO40-60 programme ( $SCE_W$ )	kWh/cycle	1. 047
Energy Efficiency Index ( $EEI_W$ )	–	41. 6
Water consumption of the ECO40-60 programme at rated capacity ( $W_{W,full}$ )	L/cycle	80. 0
Water consumption of the ECO40-60 programme at half rated capacity ( $W_{W,1/2}$ )	L/cycle	55. 0
Water consumption of the ECO40-60 programme at quarter rated capacity ( $W_{W,1/4}$ )	L/cycle	46. 0
Weighted water consumption ( $W_W$ )	L/cycle	56
Washing efficiency index of the ECO40-60 programme at rated capacity ( $I_W$ )	–	1.031
Washing efficiency index of the ECO40-60 programme at half rated capacity ( $I_W$ )	–	1.031
Washing efficiency index of the ECO40-60 programme at quarter rated capacity ( $I_W$ )	–	1.031
Rinsing effectiveness of the ECO40-60 programme at rated capacity ( $I_R$ )	g/kg	5.0
Rinsing effectiveness of the ECO40-60 programme at half rated capacity ( $I_R$ )	g/kg	5.0
Rinsing effectiveness of the ECO40-60 programme at quarter rated capacity ( $I_R$ )	g/kg	5.0

# PRODUCTS FICHE

Programme duration of the ECO40-60 programme at rated capacity ( $t_w$ )	h:min	4:00
Programme duration of the ECO40-60 programme at half rated capacity ( $t_w$ )	h:min	3:00
Programme duration of the ECO40-60 programme at quarter rated capacity ( $t_w$ )	h:min	3:00
Temperature reached for minimum 5 min inside the load during ECO40-60 programme at rated capacity (T)	°C	32
Temperature reached for minimum 5 min inside the load during ECO40-60 programme at half rated capacity (T)	°C	28
Temperature reached for minimum 5 min inside the load during ECO40-60 programme at quarter rated capacity (T)	°C	24
Spin speed in the spinning phase of the ECO40-60 programme at rated capacity (S)	rpm	1400
Spin speed in the spinning phase of the ECO40-60 programme at half rated capacity (S)	rpm	1400
Spin speed in the spinning phase of the ECO40-60 programme at quarter rated capacity (S)	rpm	1400
Remaining moisture content for the ECO40-60 programme at rated capacity ( $D_{full}$ )	%	53.90
Remaining moisture content for the ECO40-60 programme at half rated capacity ( $D_{1/2}$ )	%	53.90
Remaining moisture content for the ECO40-60 programme at quarter rated capacity ( $D_{1/4}$ )	%	53.90
Weighted remaining moisture content (D)	%	53.9
Airborne acoustical noise emissions during ECO40-60 programme (spinning phase)	dB(A) re 1 pW	76
Power consumption in 'off mode' ( $P_o$ )	W	0.50
Power consumption in 'standby mode' ( $P_{sm}$ )	W	–
Does 'standby mode' include the display of information?	–	–
Power consumption in 'standby mode' ( $P_{sm}$ ) in condition of networked standby (if applicable)	W	–
Power consumption in 'delay start' ( $P_{ds}$ ) (if applicable)	W	4.00